

## BASI PER PIEDINI Bases for legs

### RBA85-03

Base triangolare ad espansione Ø 13 mm, interasse 30 mm.  
Triangular base with expansion Ø 13 mm, pitch 30 mm.

Base per foratura da min. 25 mm a max. 32 mm.  
Base for hole drilling from 25 to max. 32 mm.

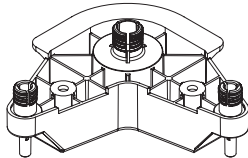

Code	unit	min. order (nr)	qty/box (nr)	Kg/box
RBA85-03	NR	180	180	-

### RBA85-04

Base triangolare ad espansione Ø 13 mm, interasse 25 mm.  
Triangular base with expansion Ø 13 mm, pitch 25 mm.

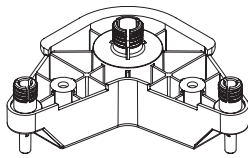

Code	unit	min. order (nr)	qty/box (nr)	Kg/box
RBA85-04	NR	200	200	-

### PF81Z

Piastra di rinforzo in ferro.  
Iron plate reinforcement.

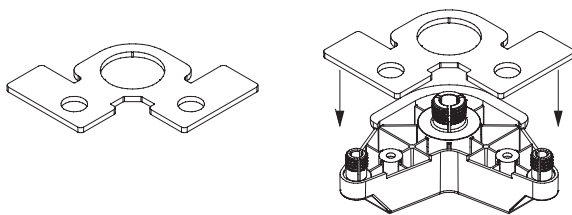

Code	unit	min. order (nr)	qty/box (nr)	Kg/box
PF81Z	NR	180	180	15,34



Consigliata per colonne armadi.  
Recommended for tall cabinets.

Basi utilizzate:  
Bases used:

- RBA85

### P74SF

Piolo ad espansione.  
Expansion pin.

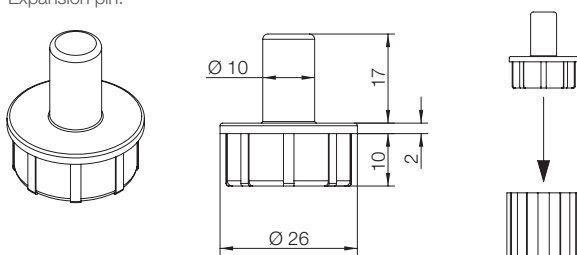

Code	unit	min. order (nr)	qty/box (nr)	Kg/box
P74SF	NR	540	540	2,70