

PIEDINI BASE Legs for base cabinet

VPF

Vite filettata M10 forata con testa piatta.
Perforated flat-head screw thread M10.

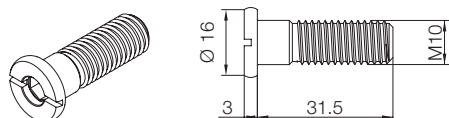

Code	unit	min. order (nr)	qty/box (nr)	Kg/box
VPF	NR	1000	1000	17,00

CF

Copriforo per vite forata.
Screw cap for drilled screw.

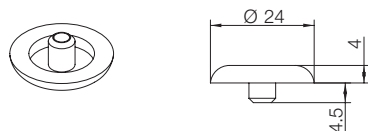

Code	unit	min. order (nr)	qty/box (nr)	Kg/box
CFA BIANCO	-	-	-	-
CFB BEIGE	-	-	-	-
CFC MARRONE	-	-	-	-
CFD TANGANICA	-	-	-	-
CFE PANNA	-	-	-	-
CFG NERO	-	-	-	-
CFH GRIGIO	-	-	-	-



Viti utilizzate:
Screws used:

- VPF

CTF0063-Z

Chiave di regolazione.
Wrench for adjustment.

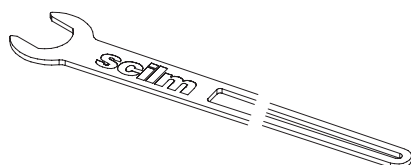

Code	unit	min. order (nr)	qty/box (nr)	Kg/box
CTF0063-Z	NR	1	1	0,20

Utilizzabile solo con piedini che portano il regolo R28C.
Only for use with legs with R28C adjuster.