

PROJECT L - LIBRERIA A SOFFITTO CEILING BOOKCASE

SPECIFICHE DI FORATURA

DRILLING SPECIFICATIONS

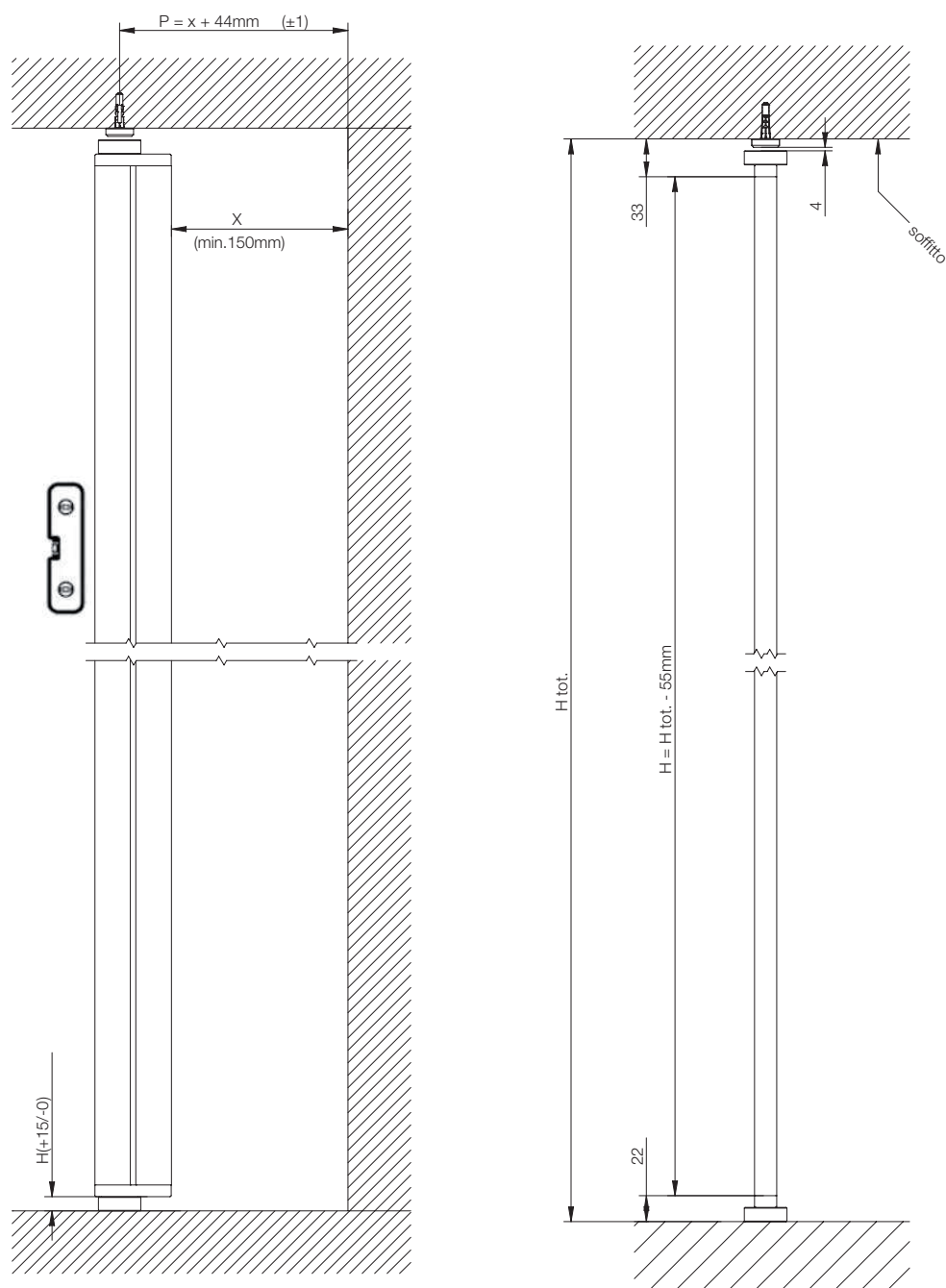

OPZIONALE - È POSSIBILE FISSARE IL MONTANTE AL MURO CON N°1 TRAVERSO
OPTIONAL: IT IS POSSIBLE TO FIX THE UPRIGHT TO THE WALL WITH 1 CROSSBEAM

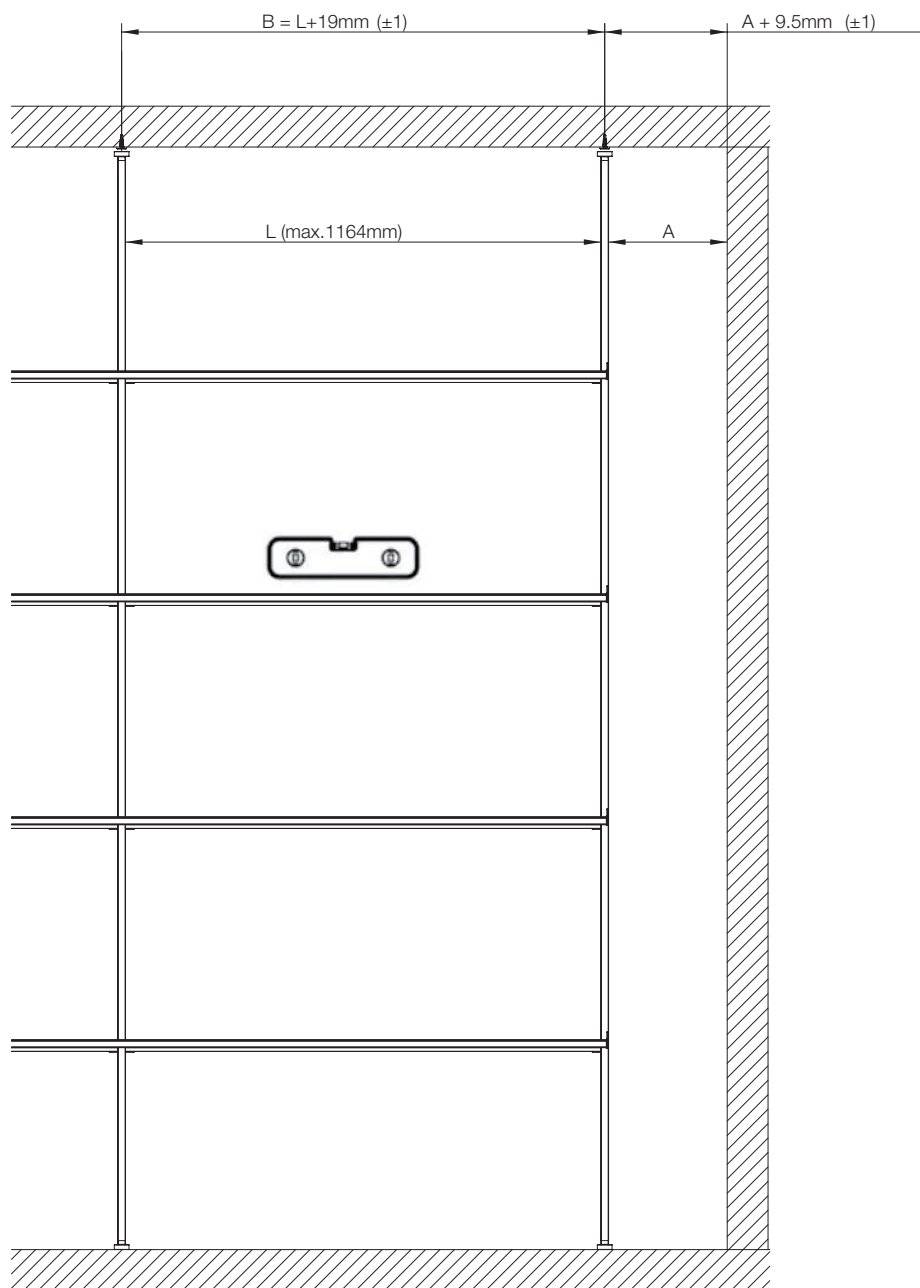

MENSOLA IN ALLUMINIO
ALUMINIUM SHELF

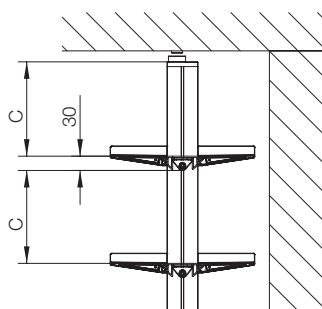

MENSOLA VETRO
GLASS SHELF

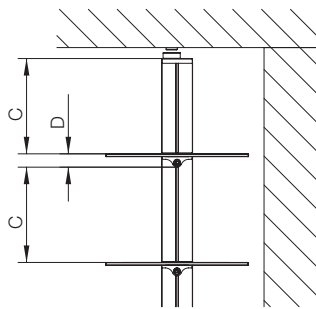

$D = \text{sp. vetro} + 22\text{mm}$
glass thickness + 22mm

MENSOLA LEGNO
WOODEN SHELF

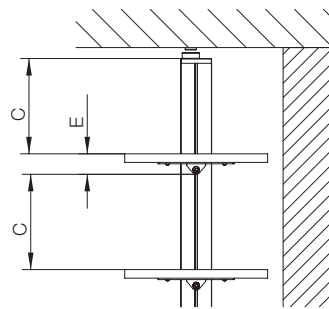

$E = \text{sp. mensola} + 25\text{mm}$
shelf thickness + 25mm

LIBRERIA A MURO WALL BOOKCASE

SPECIFICHE DI FORATURA

DRILLING SPECIFICATIONS

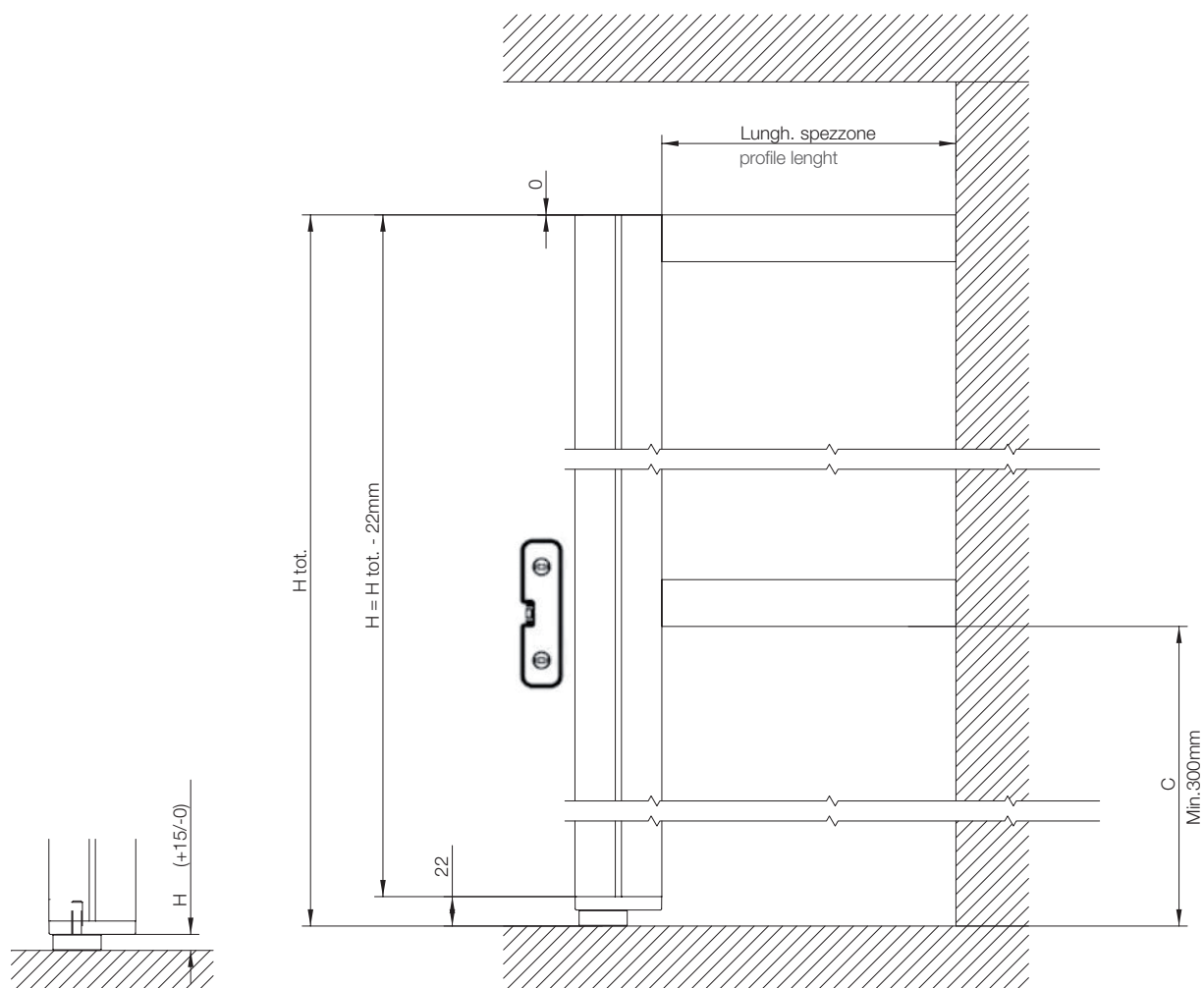

N.B. È CONSIGLIATO FISSARE IL MONTANTE AL MURO MINIMO CON N°2 TRAVERSI
 N.B. FIXING THE UPRIGHT TO THE WALL WITH MINIMUM 2 CROSSBEAMS IS RECOMMENDED

CF.6622/01

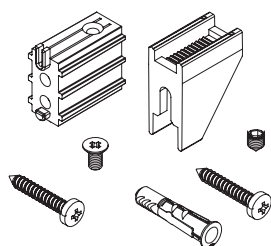

6619

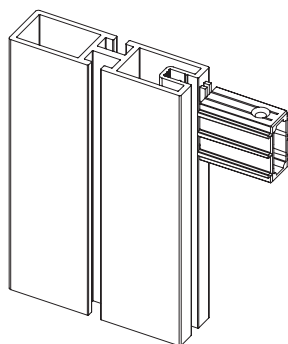

6622

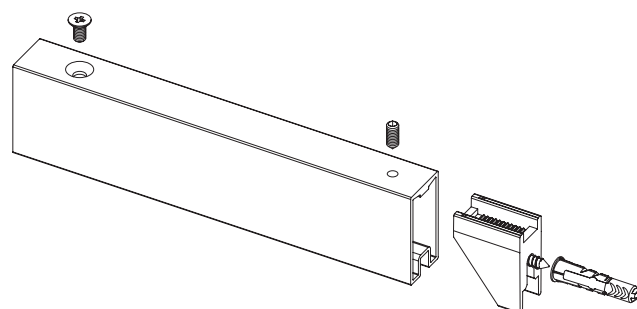

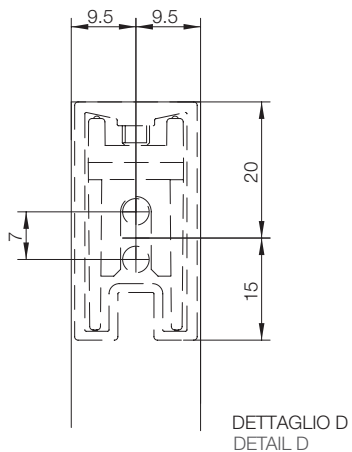
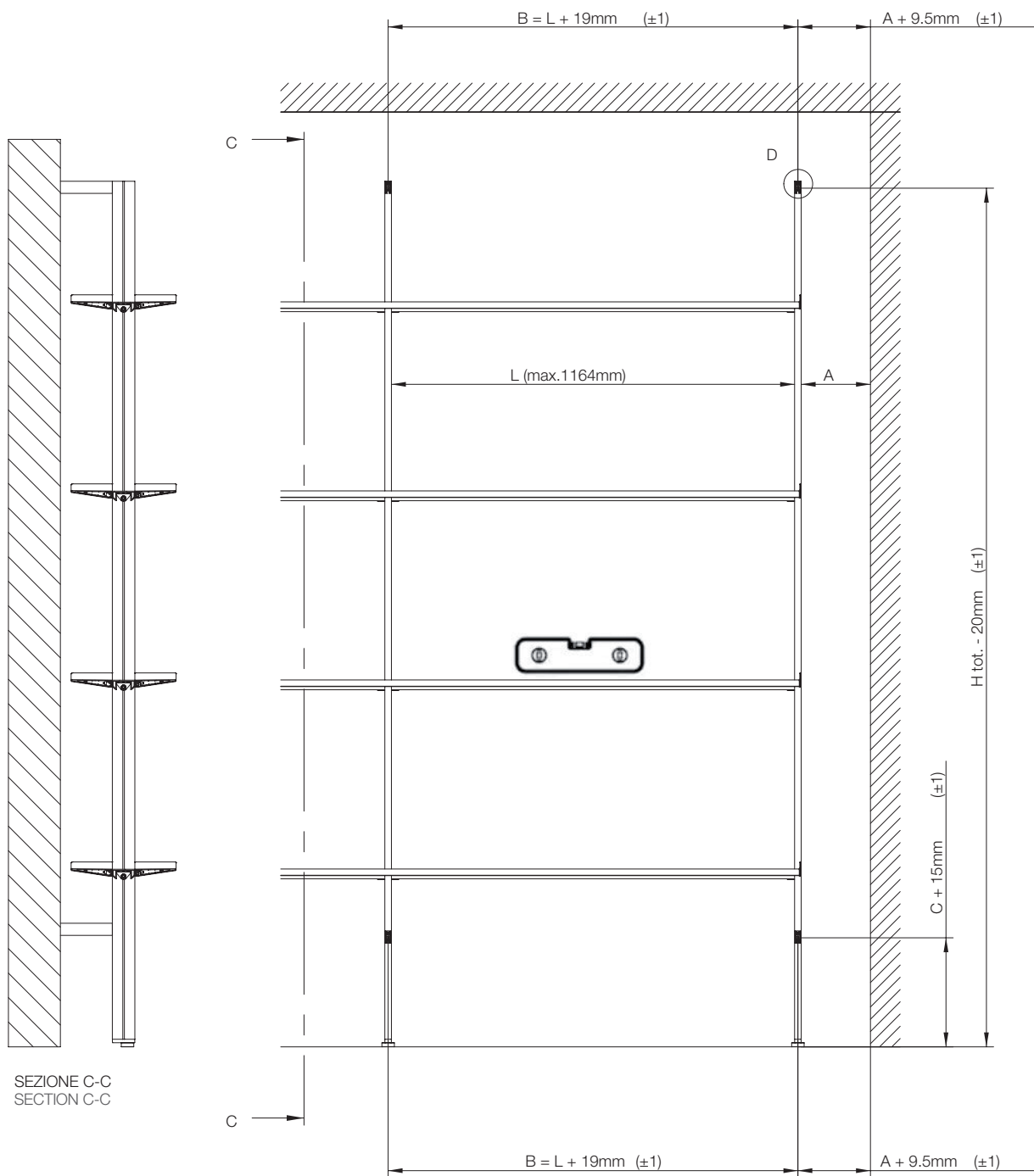

LIBRERIA BOOKCASE

TAGLIO PROFILI

EDGE PROFILES

6619

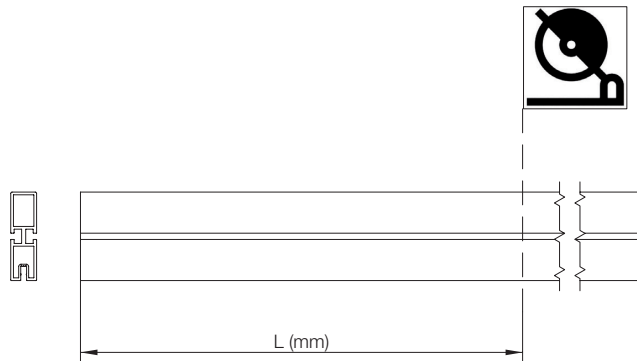

6620

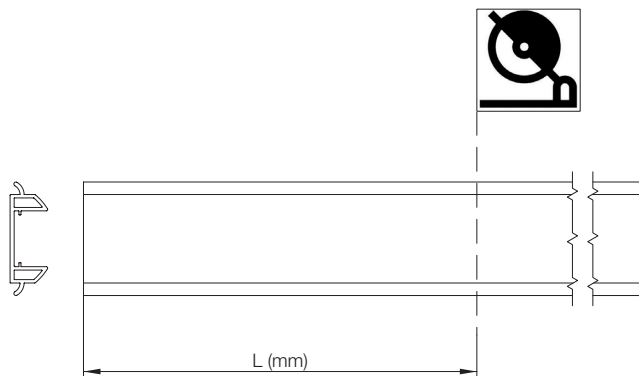

LEGENDA

L - 11 = SPEZZONE MENSOLA - (SP.TAPPO DX + SP.TAPPO SX + 1)

KEY

L-11= SHELF PIECE (RH CAP TH. - LH CAP TH.+1)

6617

6621

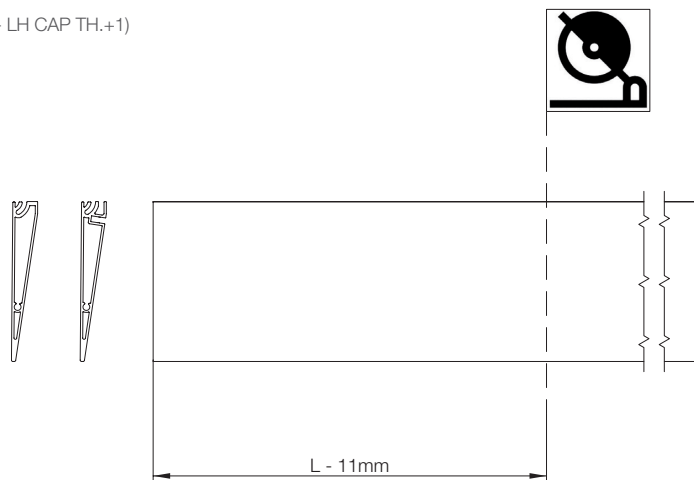

ASSEMBLAGGIO TAPPO PAVIMENTO/SOFFITTO

FLOOR / CEILING CAP ASSEMBLY

CF.6619-06/01

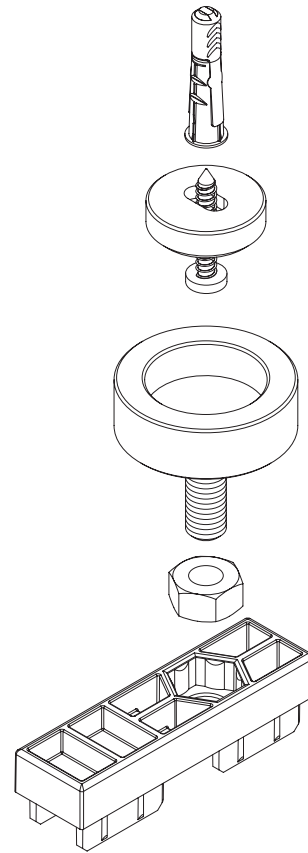
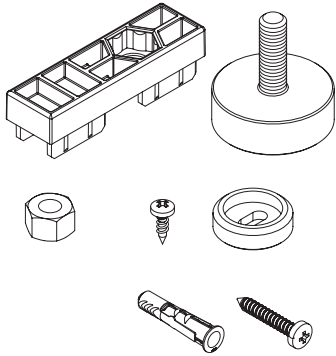

ASSEMBLAGGIO TAPPO PAVIMENTO

FLOOR CAP ASSEMBLY

CF.6619-06/02

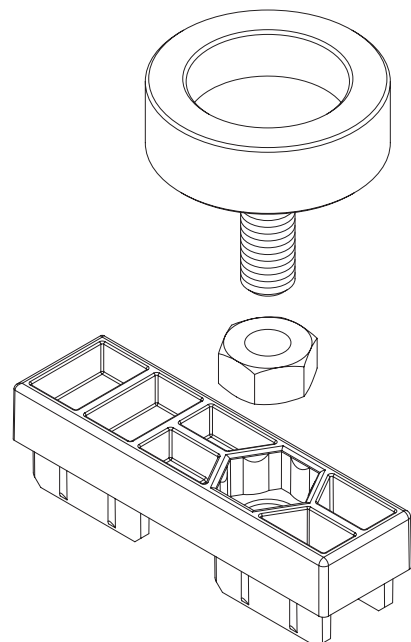
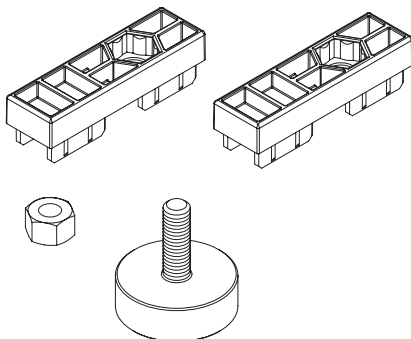

LIBRERIA BOOKCASE

ASSEMBLAGGIO MENSOIA IN ALLUMINIO

ALUMINIUM SHELF ASSEMBLY

CF.6620-06/01

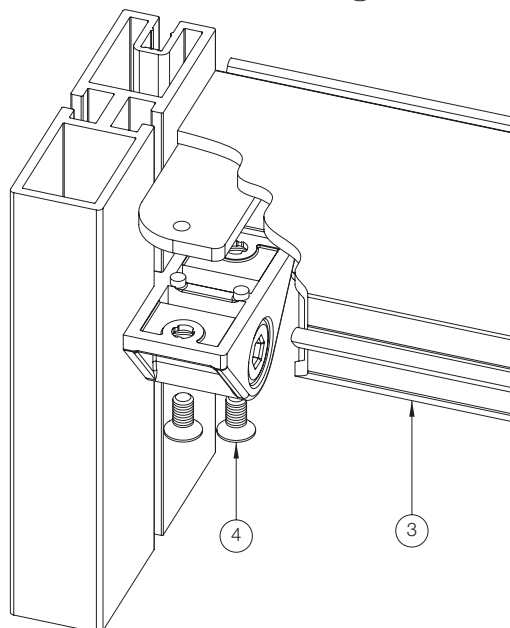
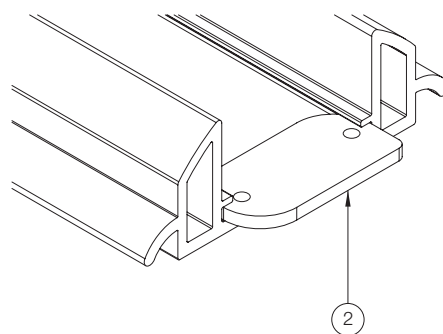
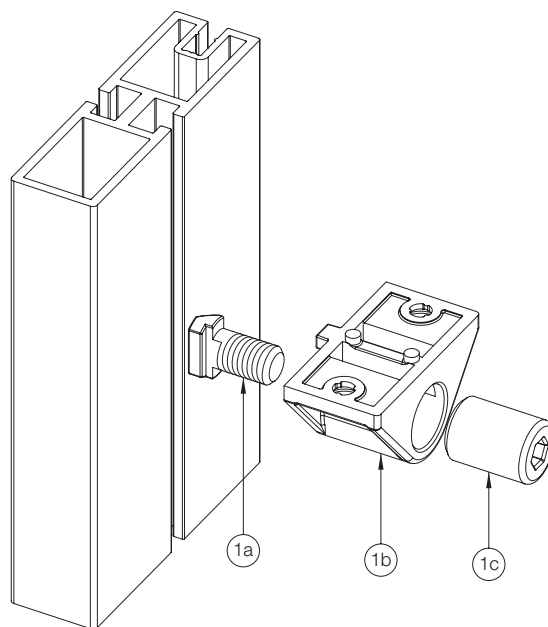
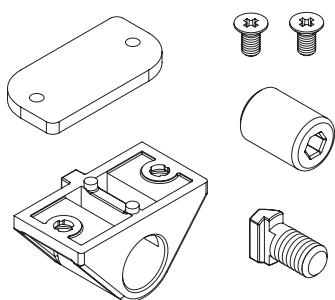

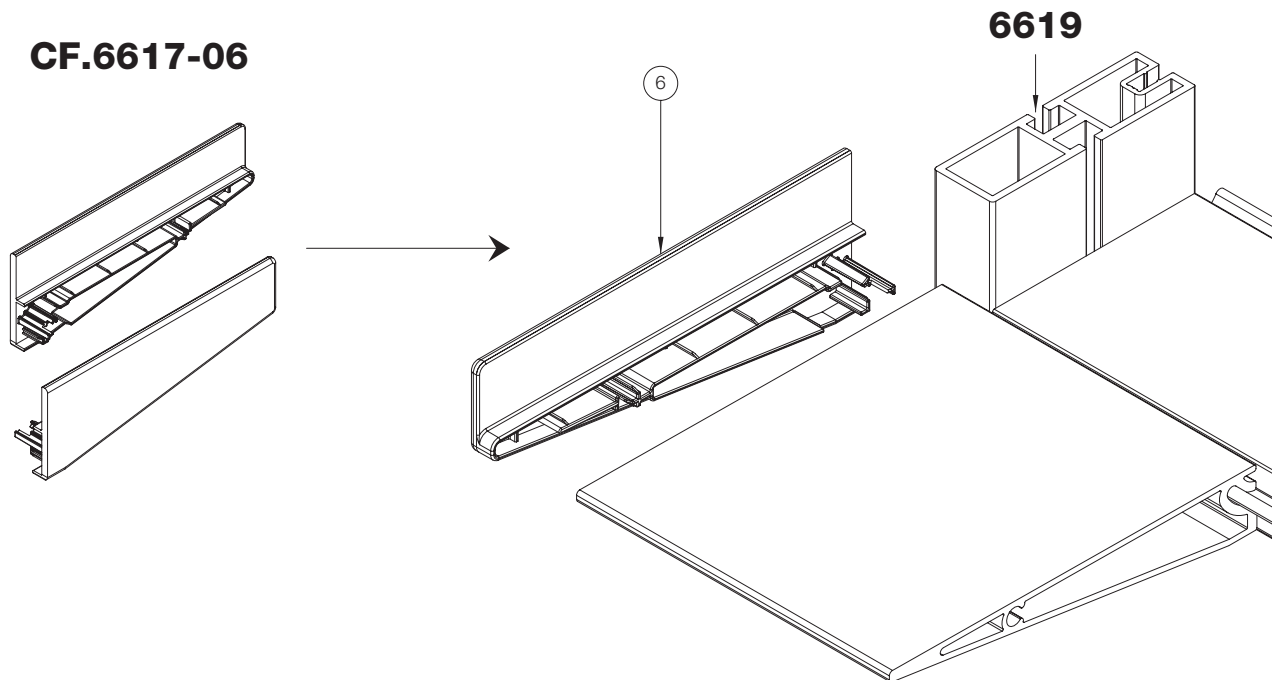
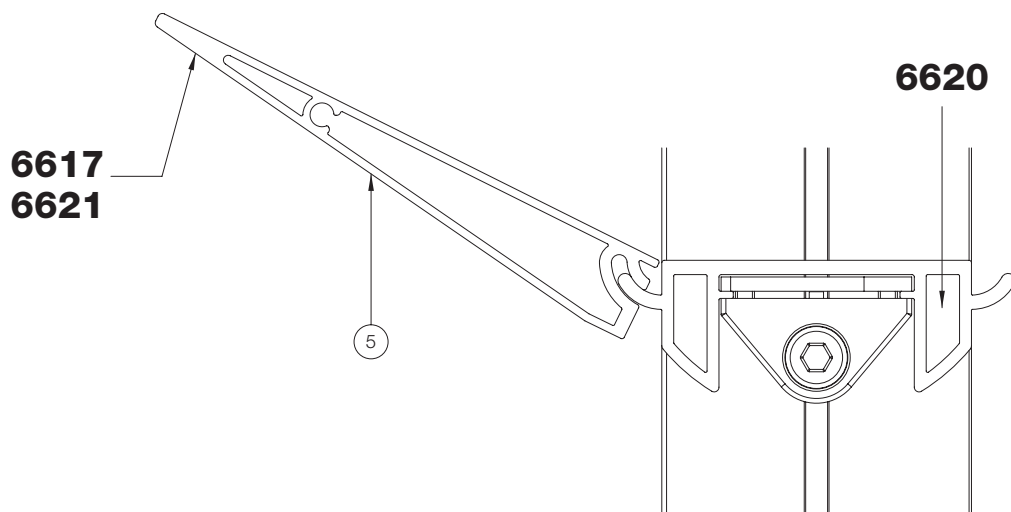

LIBRERIA BOOKCASE

ASSEMBLAGGIO MENSOLA IN VETRO

GLASS SHELF ASSEMBLY

CF.6619-06/03

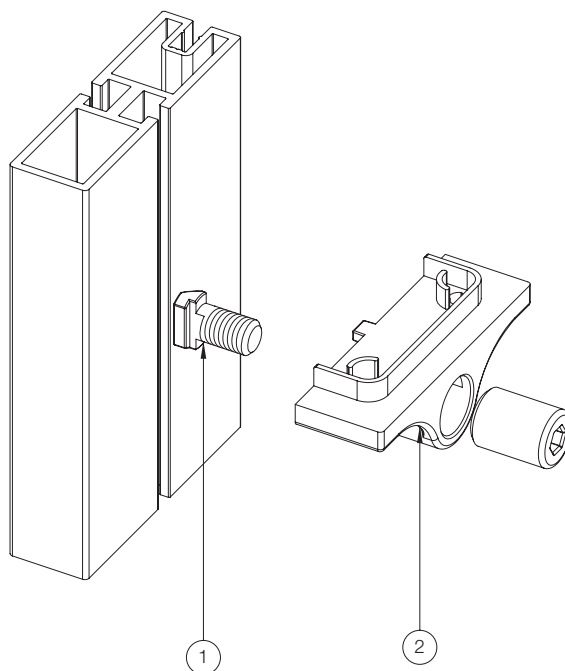
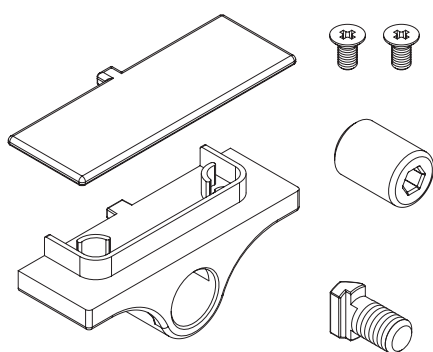

!
**SEGUIRE I NUMERI
PER I PASSAGGI ESATTI
DEL MONTAGGIO**
FOLLOW THE NUMBERS
FOR THE CORRECT
ASSEMBLY STEPS

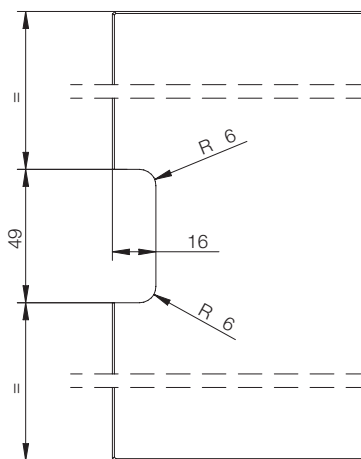
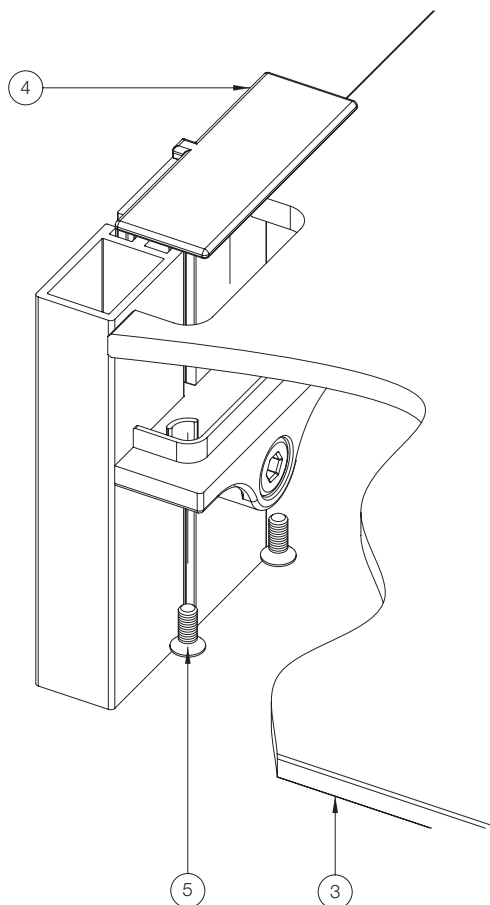

ASSEMBLAGGIO MENSOLA IN LEGNO E MOBILI

WOODEN SHELF AND FURNITURE ASSEMBLY

CF.6619-64/07

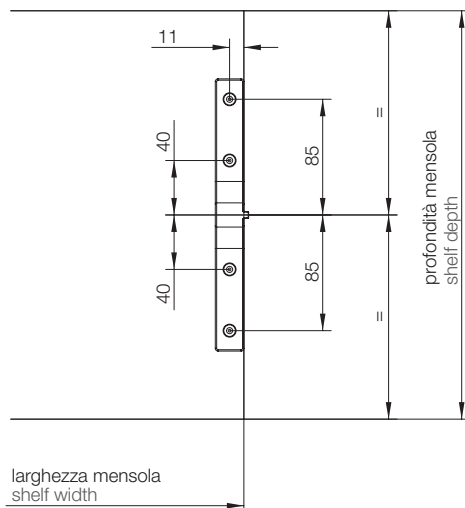
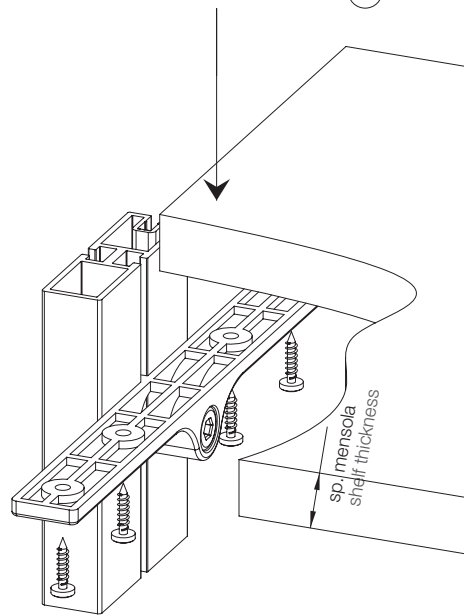
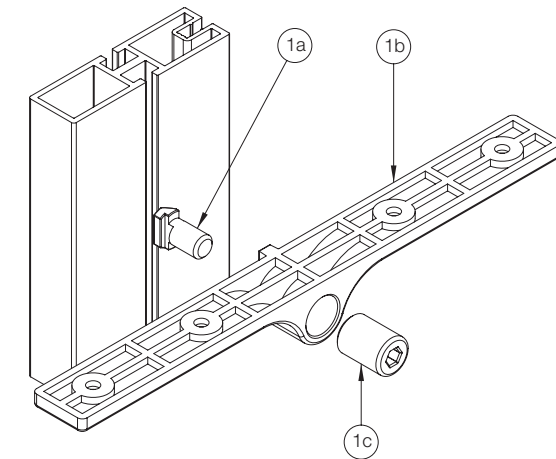
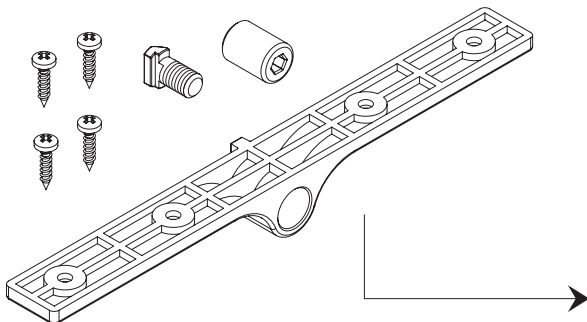

!
**SEGUIRE I NUMERI
PER I PASSAGGI ESATTI
DEL MONTAGGIO**
FOLLOW THE NUMBERS
FOR THE CORRECT
ASSEMBLY STEPS

LIBRERIA MENSOLE IN ALLUMINIO ALUMINIUM SHELF BOOKCASE

ESEMPIO DI ORDINE MATERIALE PER PROJECT1

EXAMPLE OF MATERIAL ORDER FOR PROJECT 1

MISURE STRUTTURA - 2385 mm X 2700 mm
STRUCTURE DIMENSIONS - 2385 mm X 2700 mm

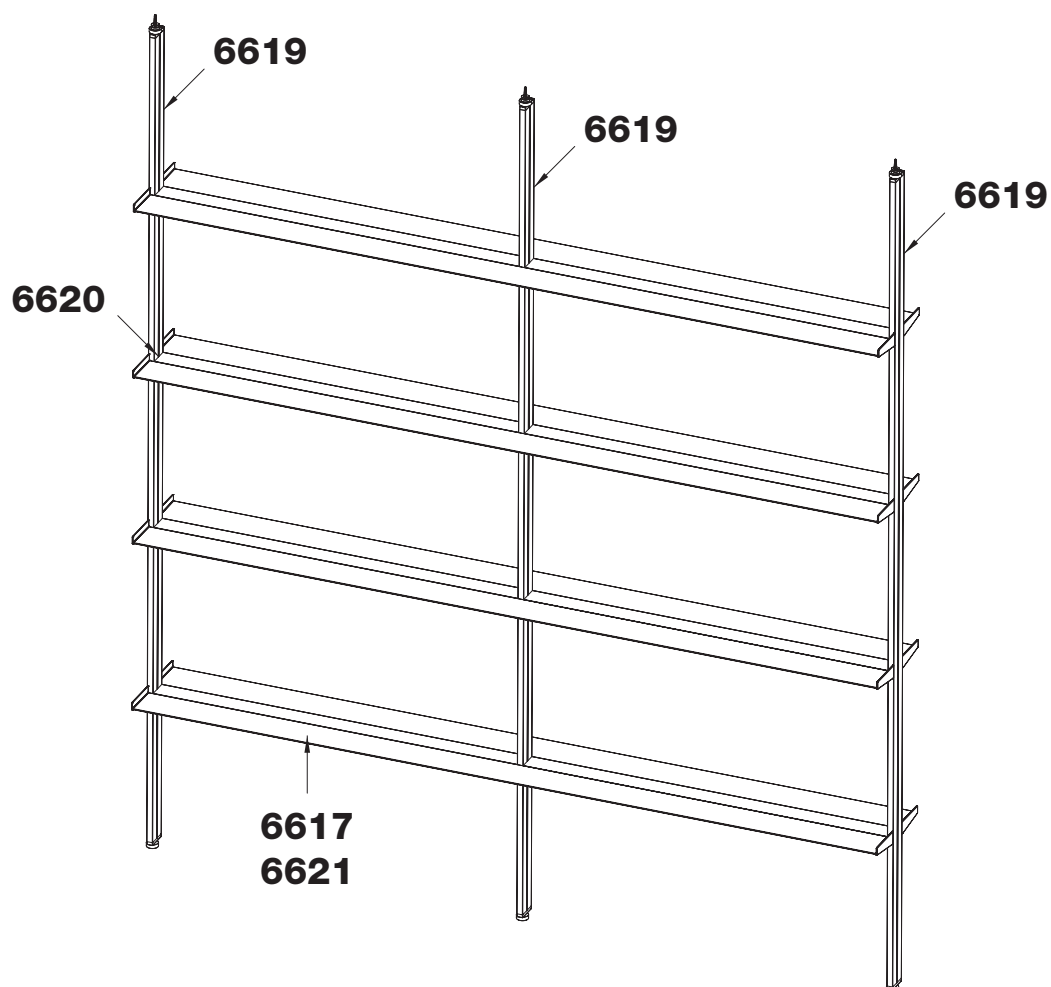

PROFILI STRUTTURA
ART.6619
N° 3pz L 2650 mm
ART.6620
N° 8pz L 1164 mm
ART.6617 / ART.6621
N° 8pz L 2374 mm

STRUCTURE PROFILES
ART.6619
No 3pcs L 2650 mm
ART.6620
No 8pcs L 1164 mm
ART.6617 / ART.6621
No 8pcs L 2374 mm

ACCESSORI STRUTTURA
CF.6619-06/01 - n°3 confezioni
CF.6620-06/01 - n°8 confezioni
CF.6617-06 - n°8 confezioni

STRUCTURE ACCESSORIES
CF.6619-06/01 - No 3 boxes
CF.6620-06/01 - No 8 boxes
CF.6617-06 - No 8 boxes

CABINA ARMADIO WALK-IN WARDROBE

SPECIFICHE DI FORATURA

DRILLING SPECIFICATIONS

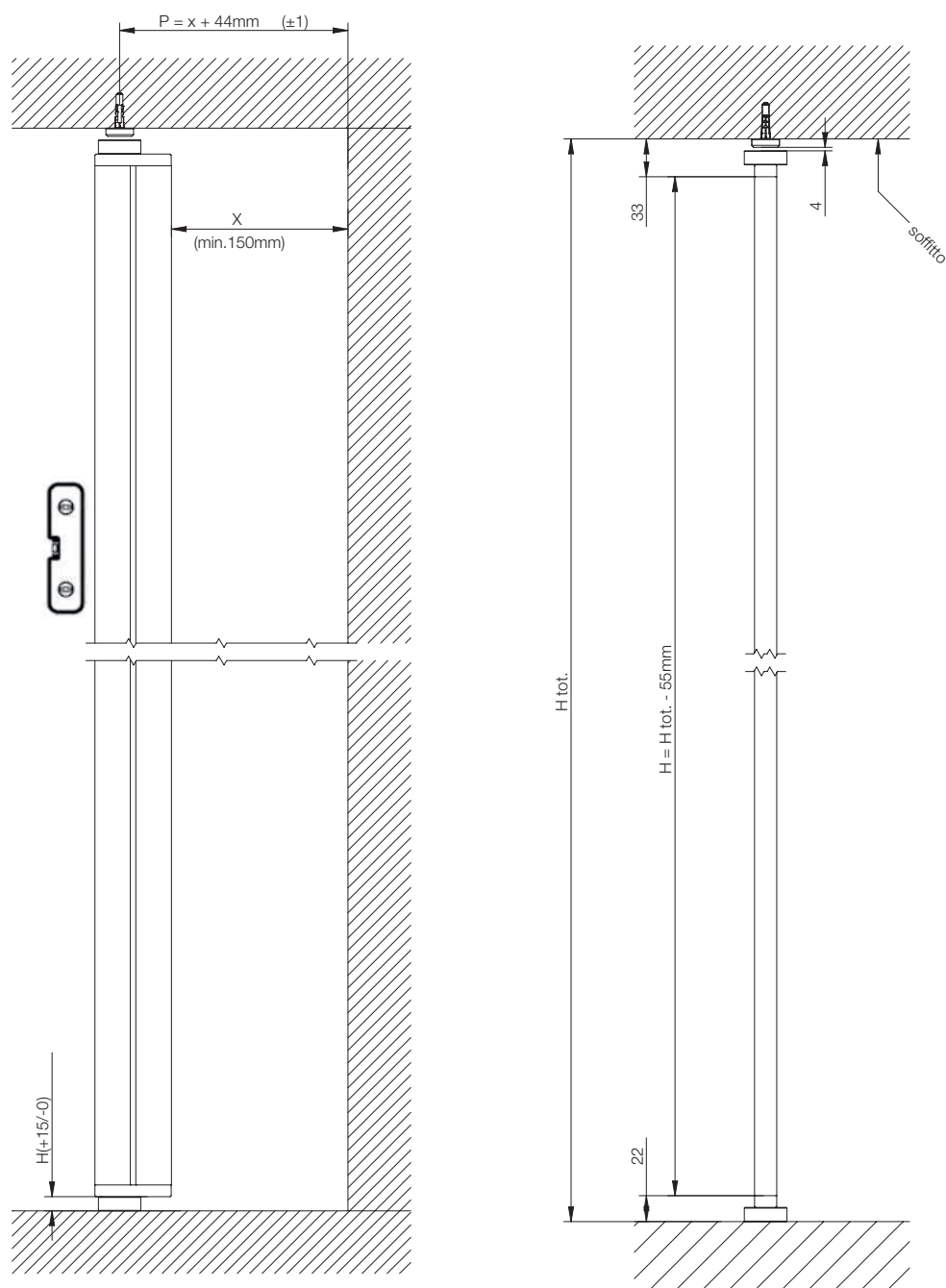

OPZIONALE - È POSSIBILE FISSARE IL MONTANTE AL MURO CON N°1 TRAVERSO
OPTIONAL: IT IS POSSIBLE TO FIX THE UPRIGHT TO THE WALL WITH 1 CROSSBEAM

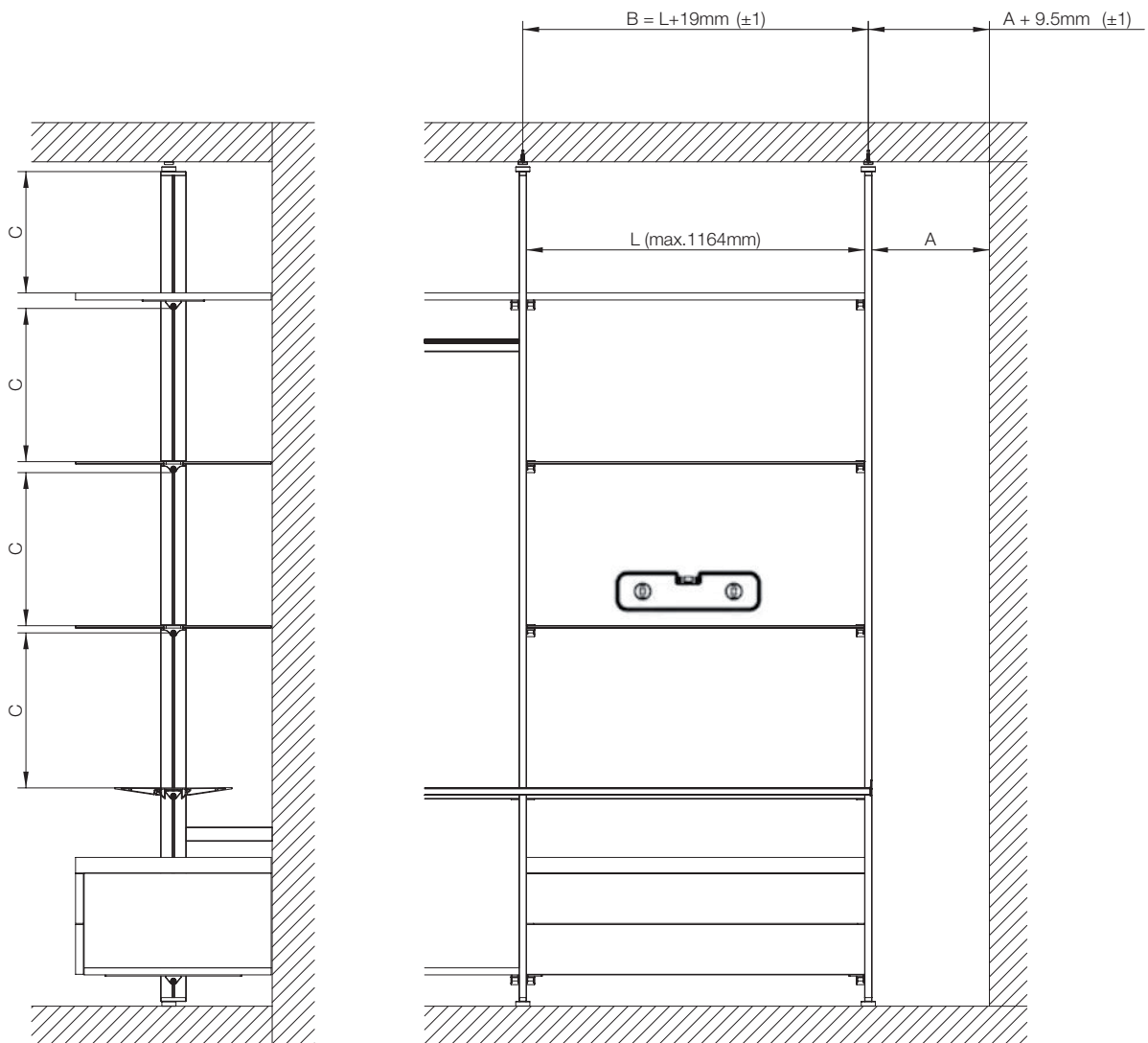

MENSOLA IN ALLUMINIO
ALUMINIUM SHELF

MENSOLA VETRO
GLASS SHELF

MENSOLA LEGNO
WOODEN SHELF

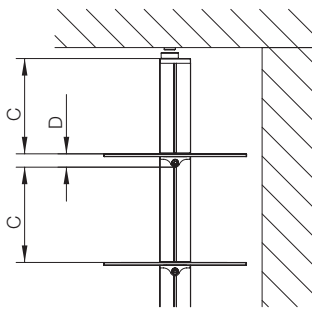
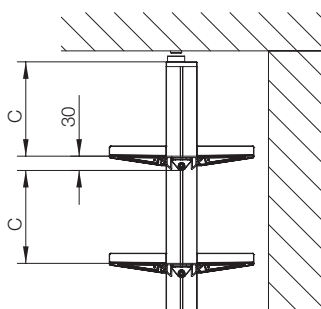

$D = \text{sp. vetro} + 22\text{mm}$
glass thickness + 22mm

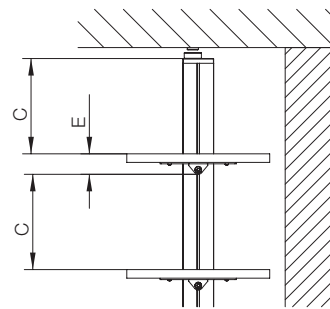

$E = \text{sp. mensola} + 25\text{mm}$
shelf thickness + 25mm

CABINA ARMADIO WALK-IN WARDROBE

SPECIFICHE DI FORATURA

DRILLING SPECIFICATIONS

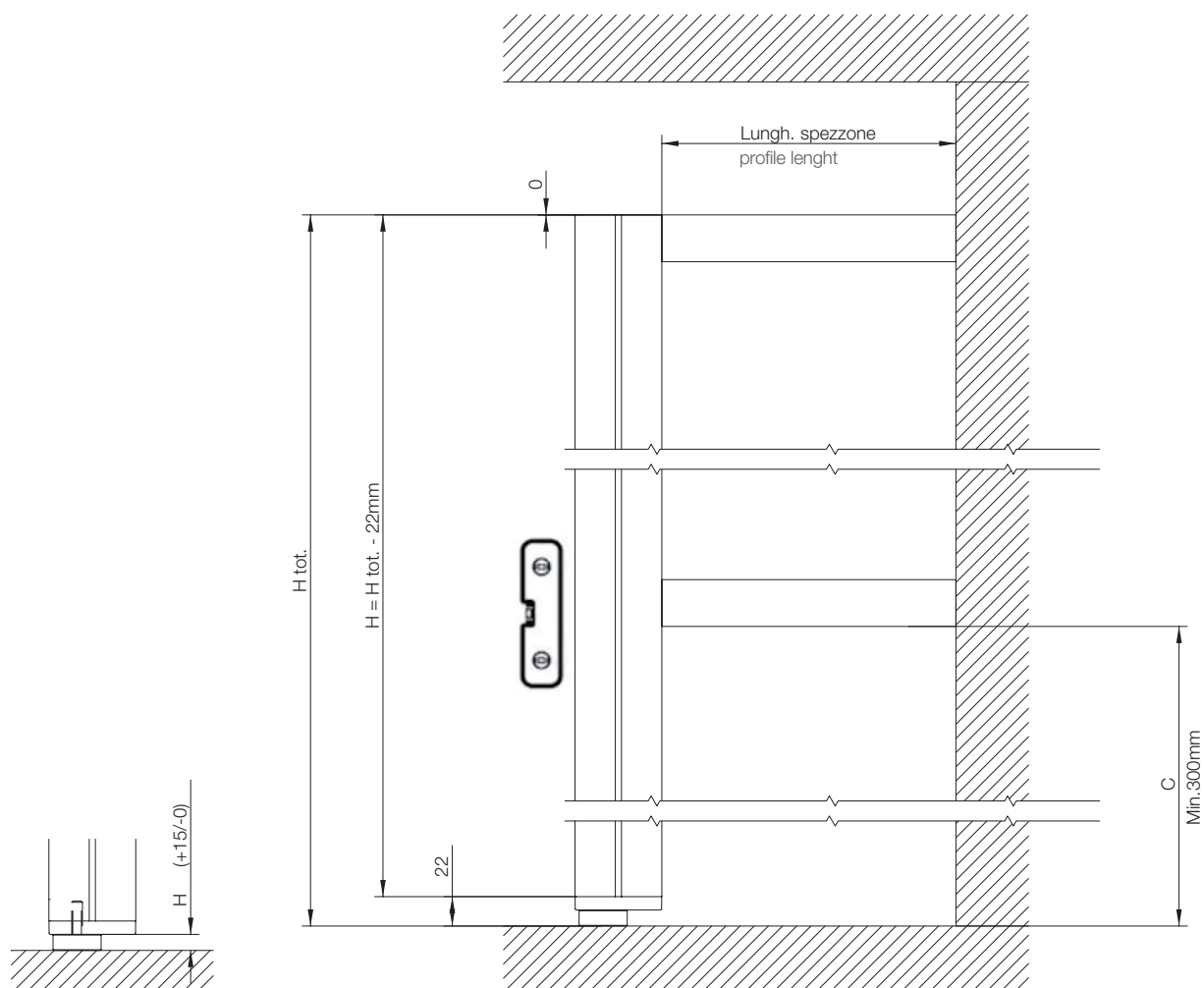

N.B. È CONSIGLIATO FISSARE IL MONTANTE AL MURO MINIMO CON N°2 TRAVERSI
N.B. FIXING THE UPRIGHT TO THE WALL WITH MINIMUM 2 CROSSBEAMS IS RECOMMENDED

CF.6622/01

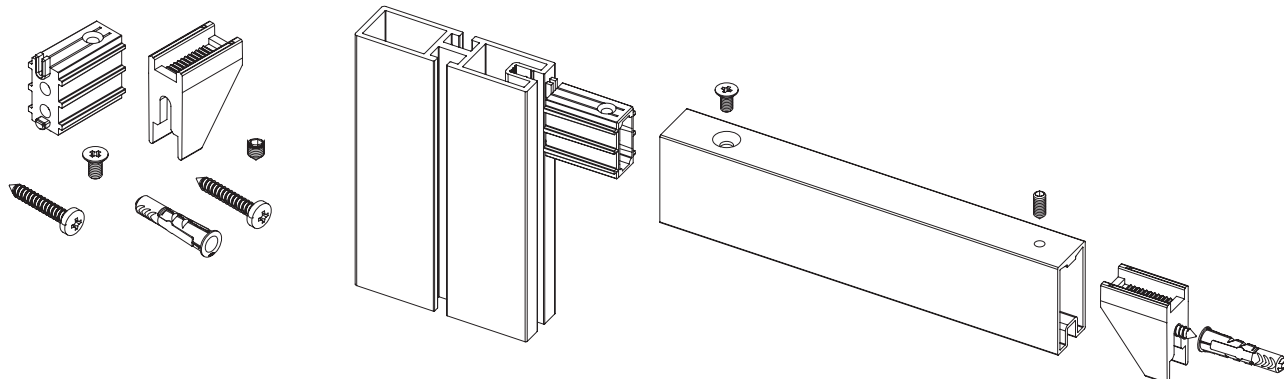

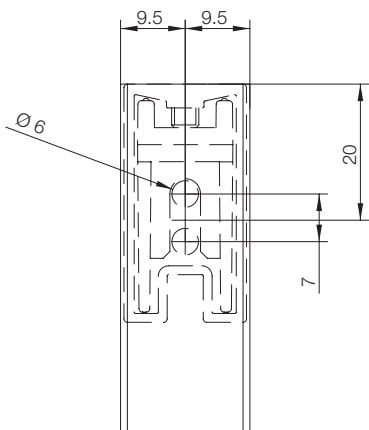
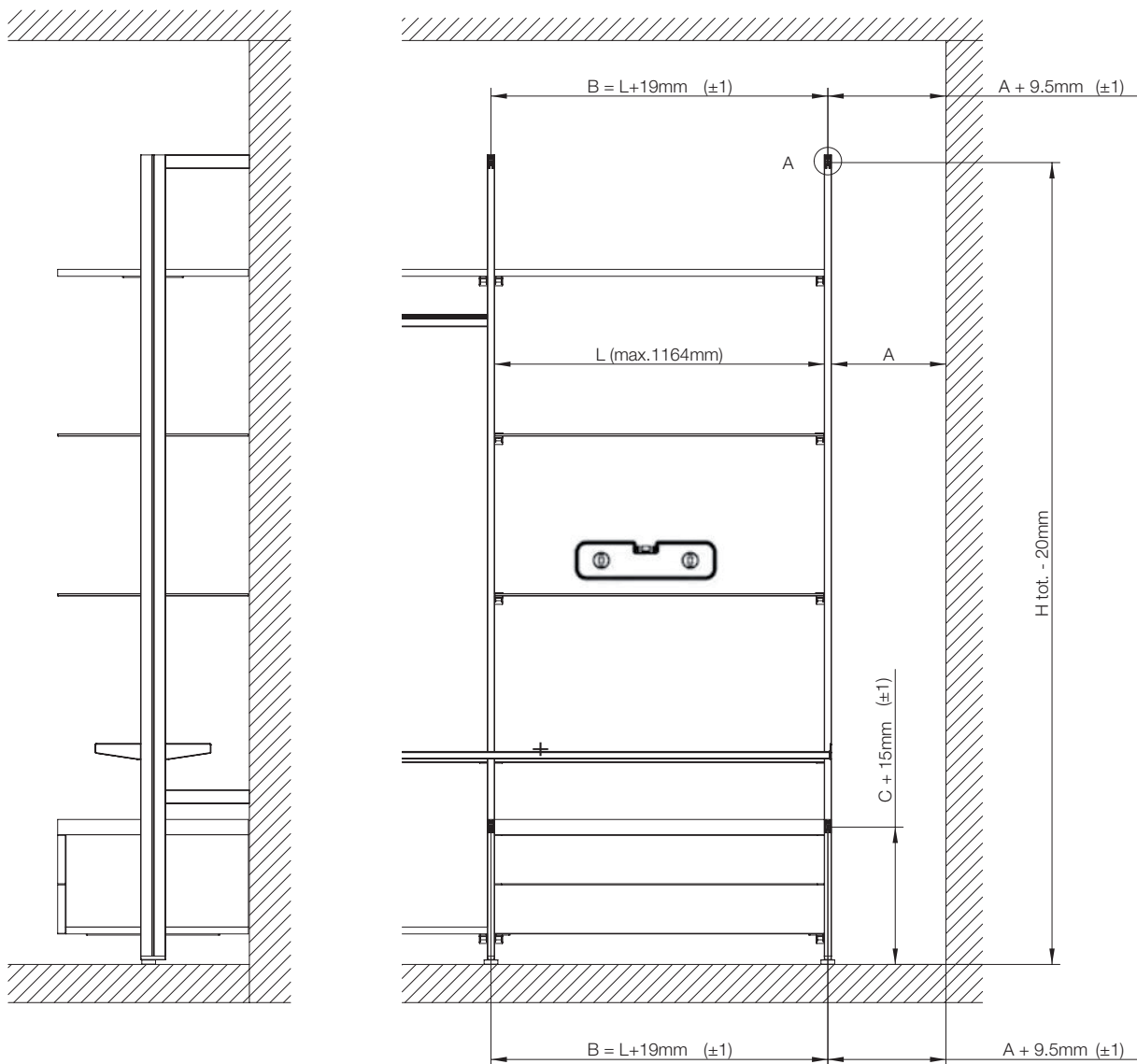

CABINA ARMADIO WALK-IN WARDROBE

TAGLIO PROFILI

EDGE PROFILES

6619

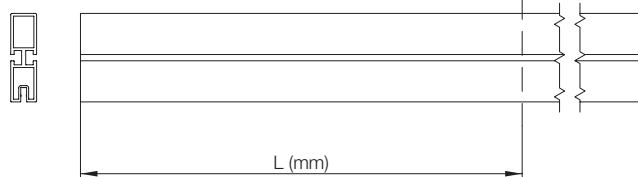

6620

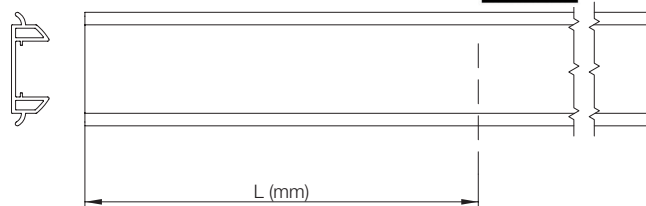

LEGENDA

L - 11 = SPEZZONE MENSOLA - (SP.TAPPO DX + SP.TAPPO SX + 1)

KEY

L-11= SHELF PIECE (RH CAP TH. - LH CAP TH.+1)

6617

6621

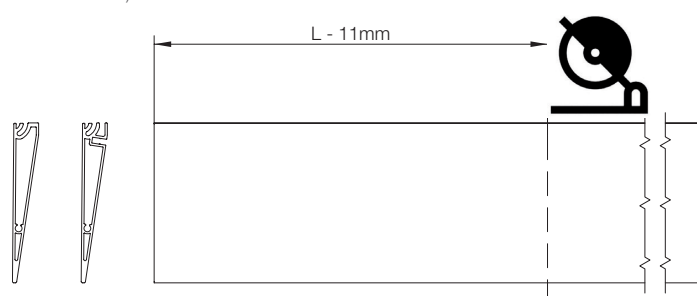

6623

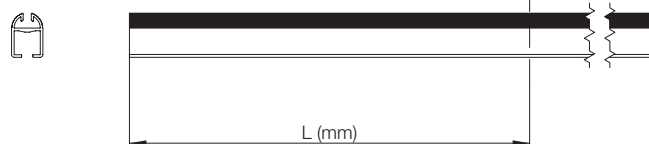

ASSEMBLAGGIO TAPPO PAVIMENTO/SOFFITTO

FLOOR / CEILING CAP ASSEMBLY

CF.6619-06/01

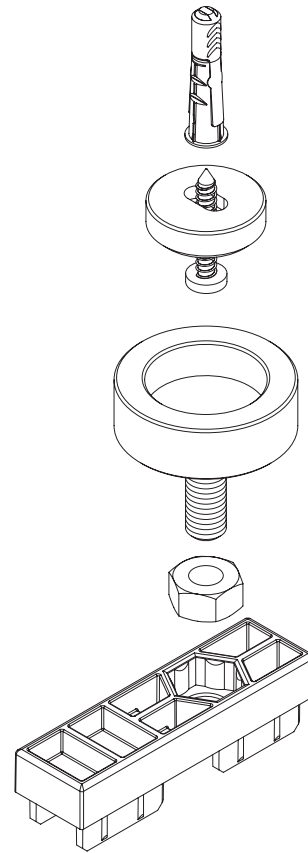
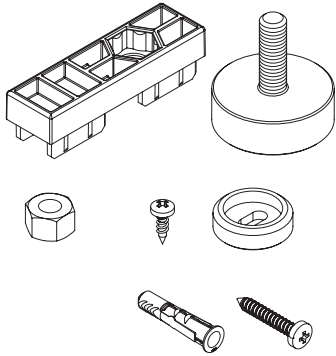

ASSEMBLAGGIO TAPPO PAVIMENTO

FLOOR CAP ASSEMBLY

CF.6619-06/02

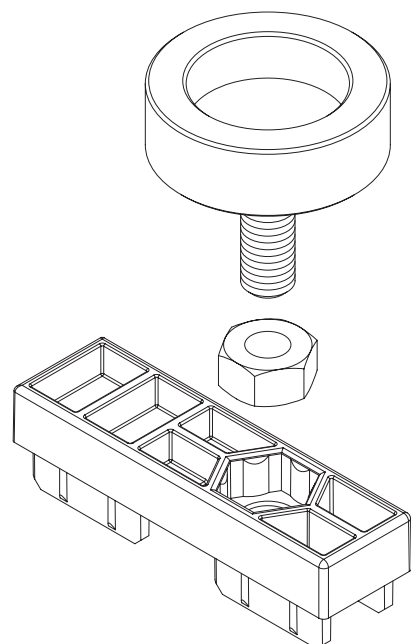
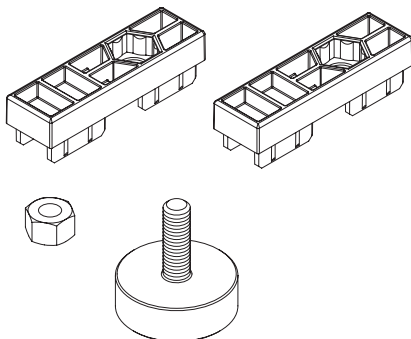

CABINA ARMADIO WALK-IN WARDROBE

ASSEMBLAGGIO MENSOLO IN ALLUMINIO

ALUMINIUM SHELF ASSEMBLY

CF.6620-06/01

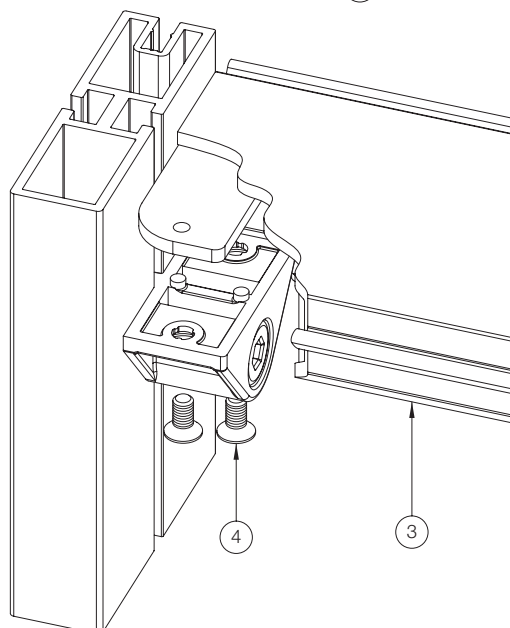
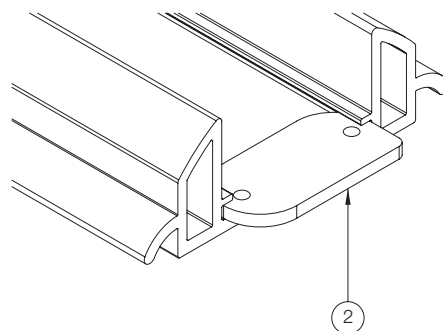
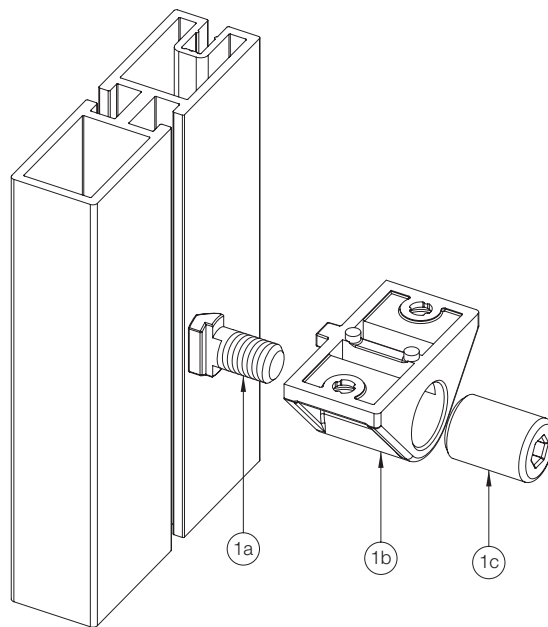
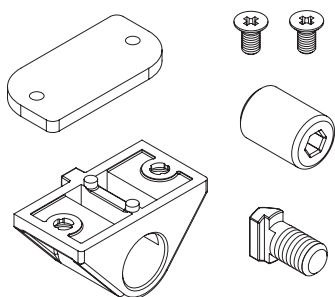

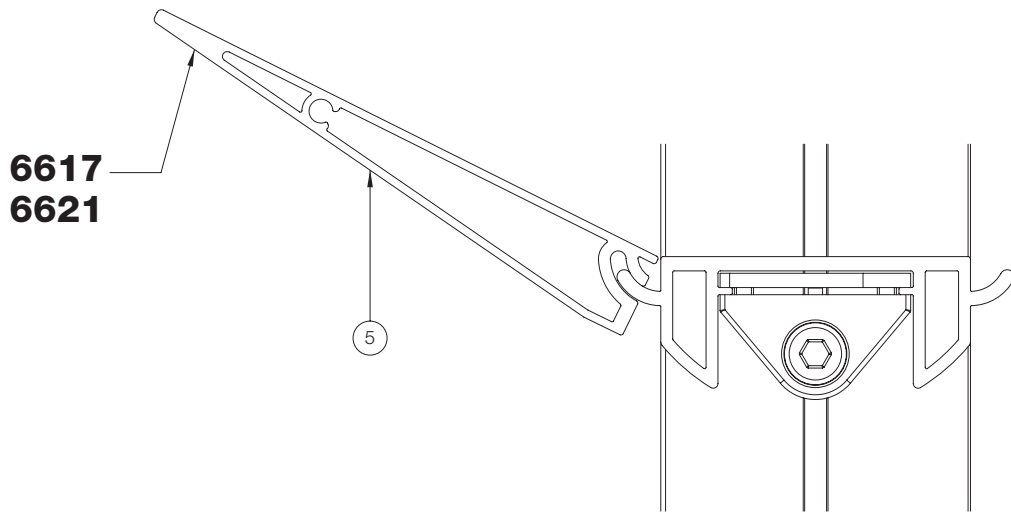

CF.6617-06

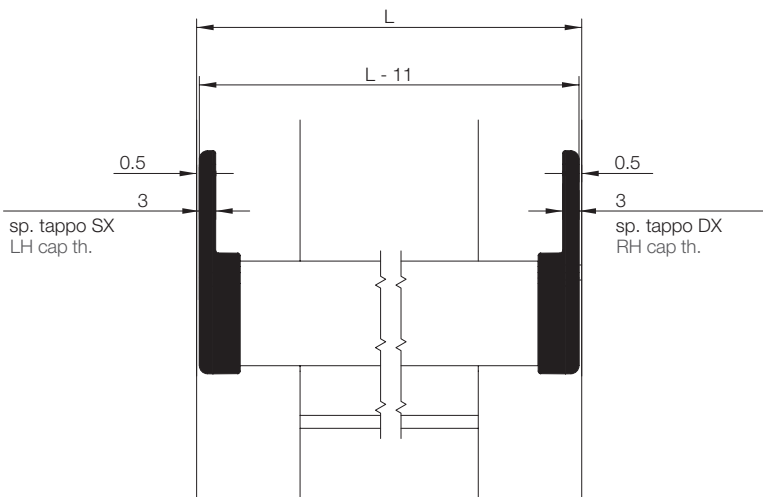
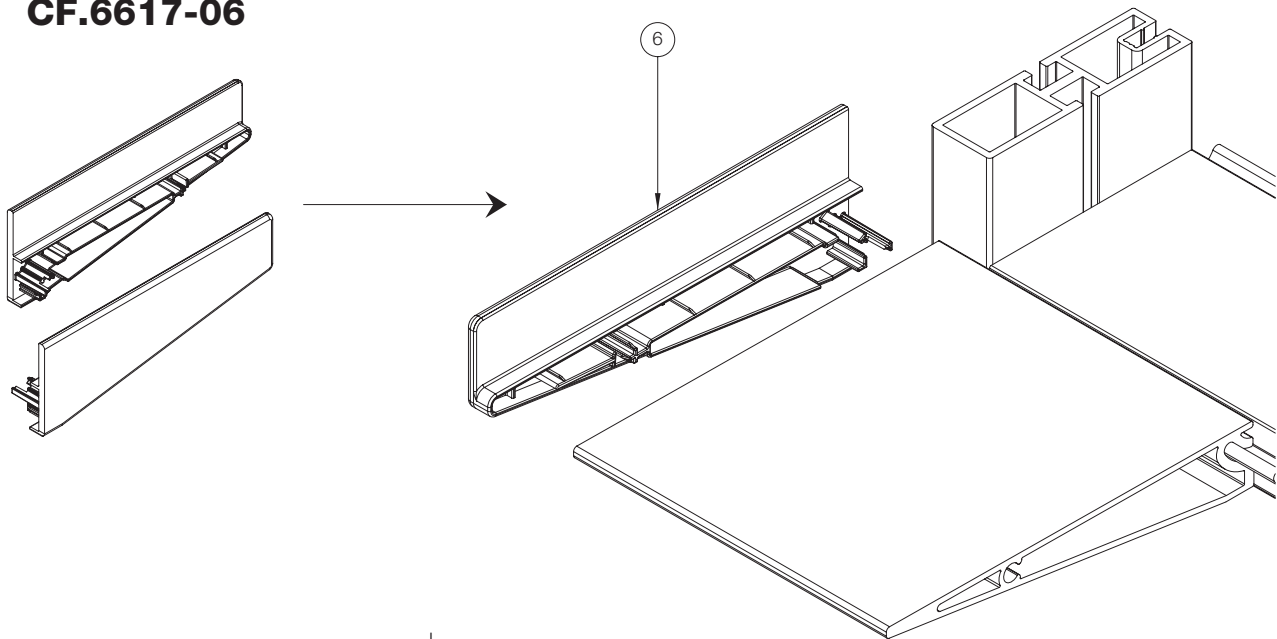

CABINA ARMADIO WALK-IN WARDROBE

ASSEMBLAGGIO MENSOLA IN VETRO

GLASS SHELF ASSEMBLY

CF.6619-06/03

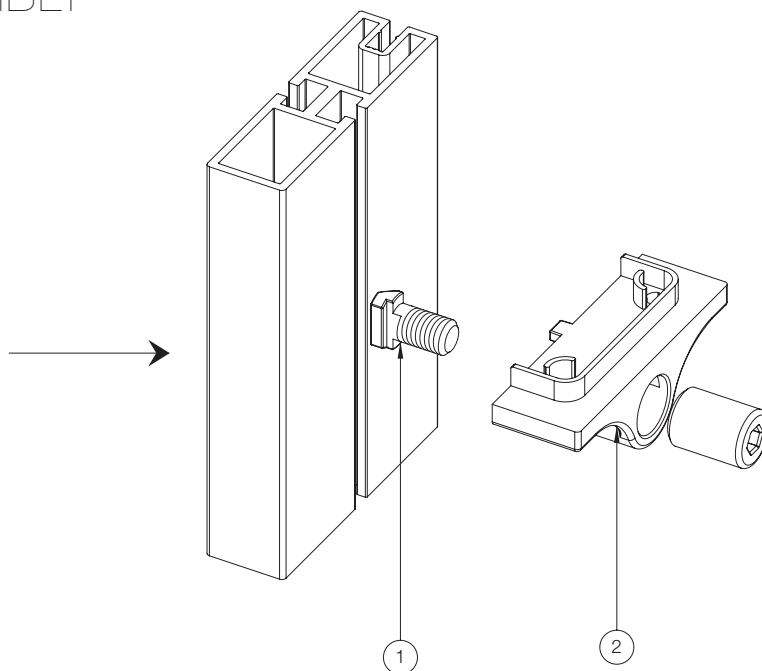
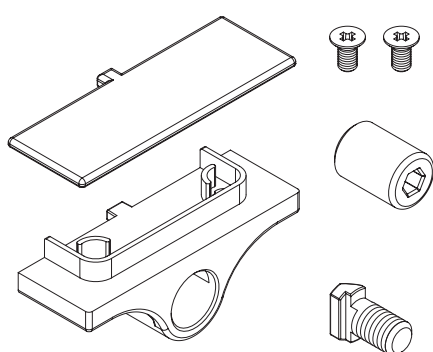

!
**SEGUIRE I NUMERI
PER I PASSAGGI ESATTI
DEL MONTAGGIO**
FOLLOW THE NUMBERS
FOR THE CORRECT
ASSEMBLY STEPS

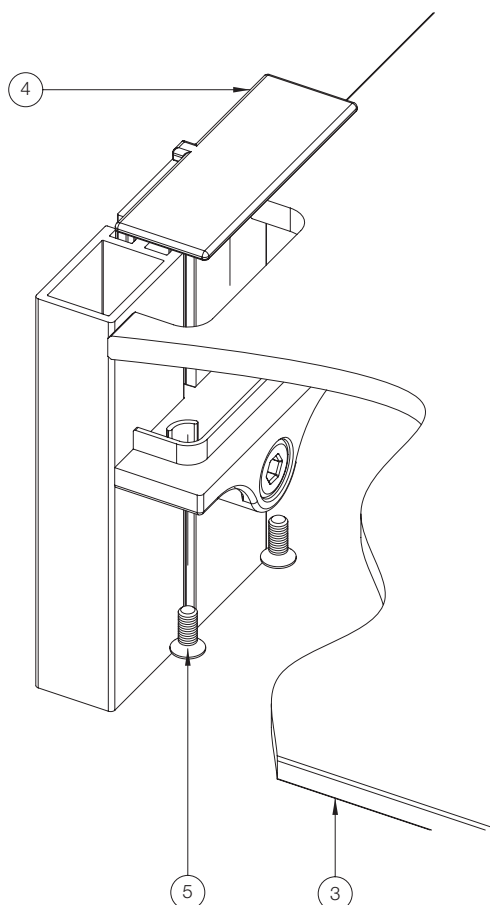
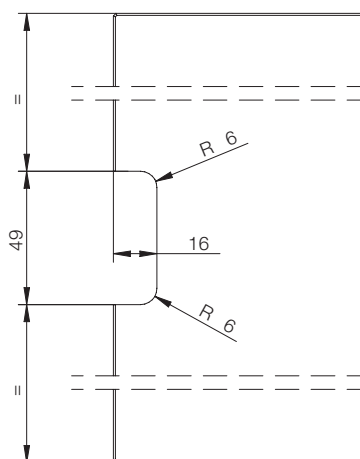

ASSEMBLAGGIO MENSOLA IN LEGNO E MOBILI

WOODEN SHELF AND FURNITURE ASSEMBLY

CF.6619-64/07

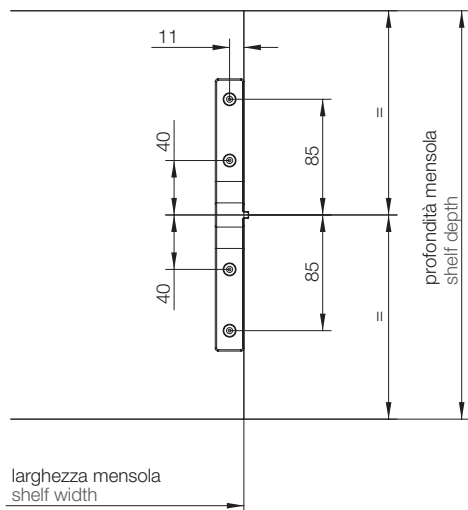
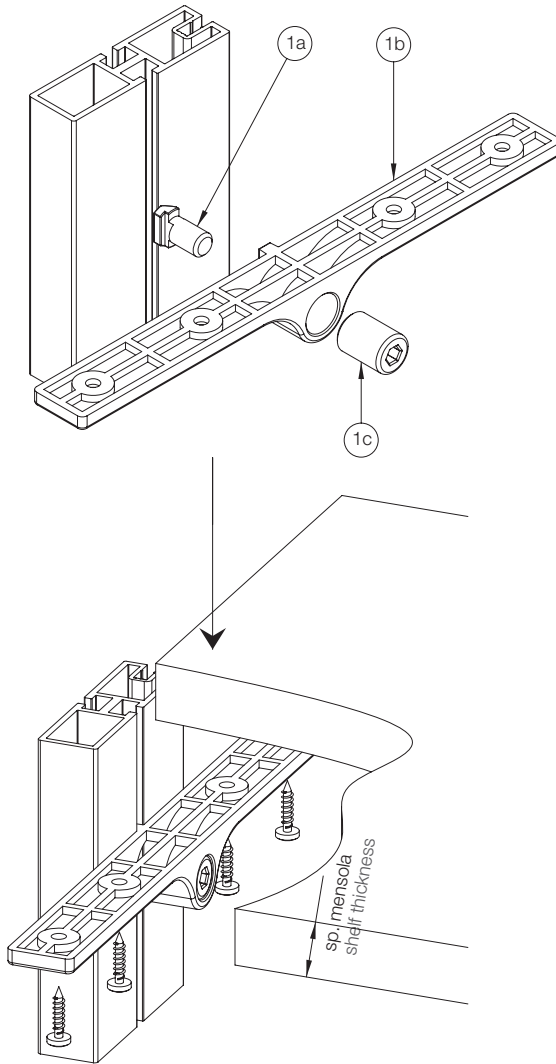
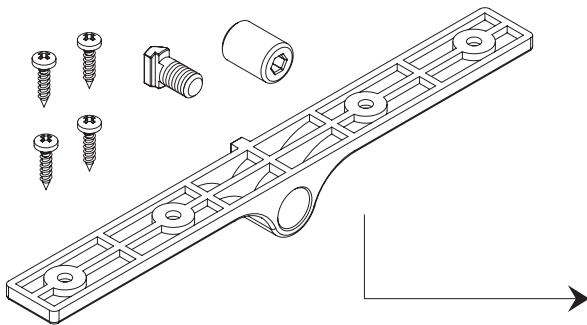

!
**SEGUIRE I NUMERI
PER I PASSAGGI ESATTI
DEL MONTAGGIO**
FOLLOW THE NUMBERS
FOR THE CORRECT
ASSEMBLY STEPS

CABINA ARMADIO WALK-IN WARDROBE

ASSEMBLAGGIO PROFILO APPENDIABILI

COAT STAND PROFILE

CF.6616-06/01

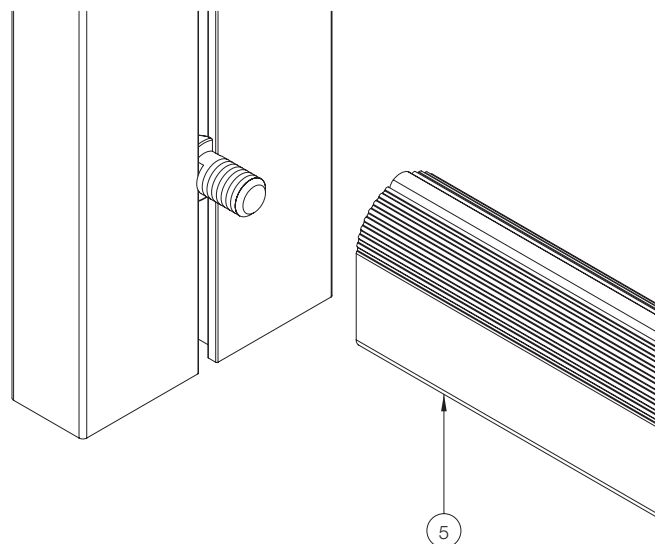
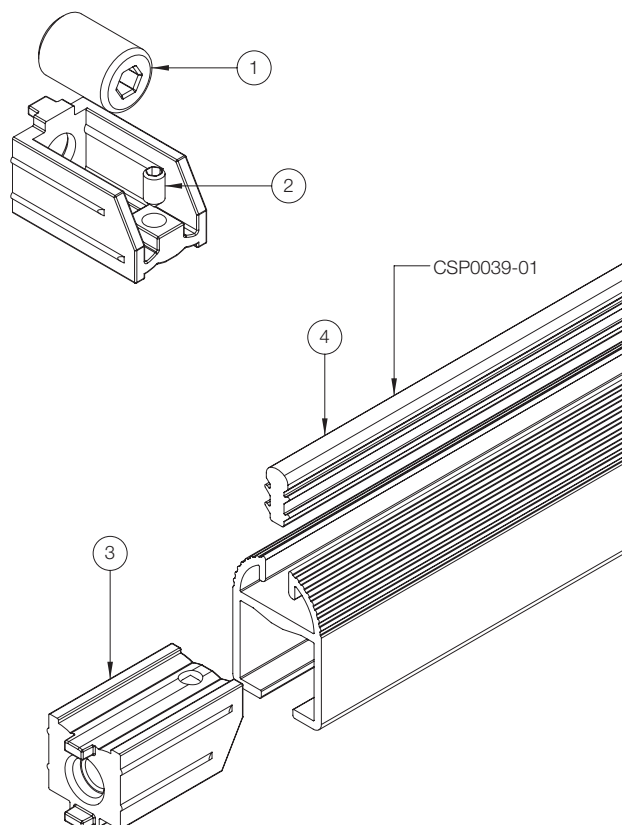
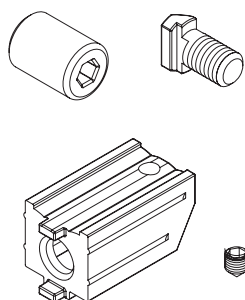

ESEMPIO DI ORDINE

MATERIALE PER CABINA ARMADIO

EXAMPLE OF MATERIAL ORDER FOR WALK-IN WARDROBE

MISURE STRUTTURA - 1285 mm X 2100 mm
 STRUCTURE DIMENSIONS - 1285 mm X 2100 mm

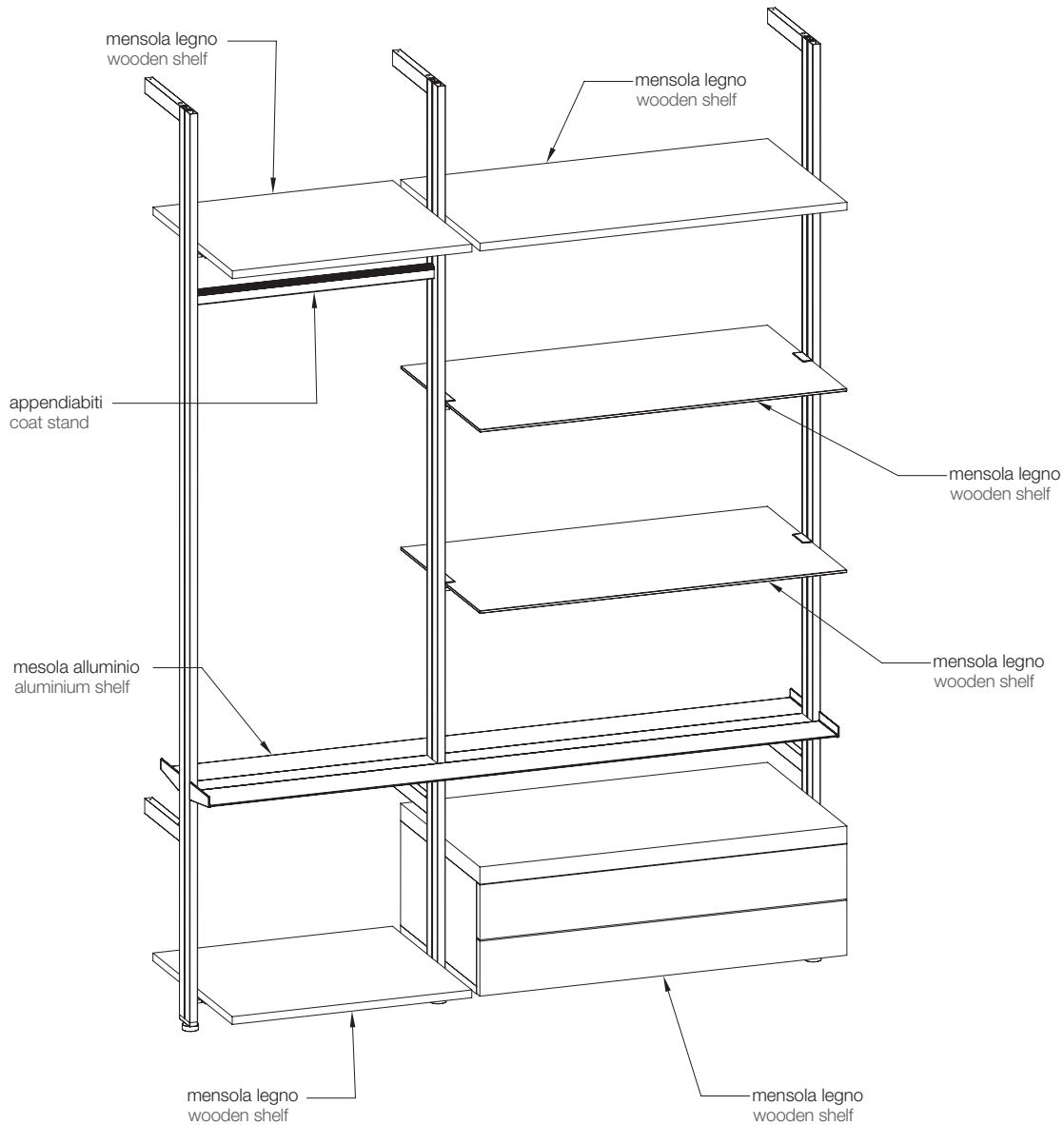

PROFILI STRUTTURA
 ART.6619
 N° 3pz L 2100 mm
 ART.6620
 N° 1pz L 564 mm
 N° 1pz L 864 mm
 ART.6617 / ART.6621
 N° 2pz L 1274 mm
 ART.6623
 N° 1 pz L 564 mm
 ART.6622
 N° 6 pz L150 mm

STRUCTURE PROFILES
 ART.6619
 No 3pcs L 2100 mm
 ART.6620
 No 1pc L 564 mm
 No 1pc L 864 mm
 ART.6617 / ART.6621
 No 2pcs L 1274 mm
 ART.6623
 No 1 pc L 564 mm
 ART.6622
 No 6 pcs L150 mm

ACCESSORI STRUTTURA
 CF.6619-06/02 - n°3 confezioni
 CF.6619-06/03 - n°2 confezioni
 CF.6619-64/07 - n°3 confezioni
 CF.6620-06/01 - n°2 confezioni
 CF.6617-06 - n°2 confezioni
 CF.6622/01 - n°6 confezioni
 CF.6616-06/01 - n°1 confezioni

STRUCTURE ACCESSORIES
 CF.6619-06/02 - No 3 boxes
 CF.6619-06/03 - No 2 boxes
 CF.6619-64/07 - No 3 boxes
 CF.6620-06/01 - No 2 boxes
 CF.6617-06 - No 2 boxes
 CF.6622/01 - No 6 boxes
 CF.6616-06/01 - No 1 box