

PIEDINI CONICI Conical legs

250F R28C

Piedino conico H 60, 70, 80.
Conical leg H 60, 70, 80.

Con base frigo 877, 878, 879, 865, 881 e T6567 regolazione solo frontale con chiave inglese n°26.

With refrigerator cabinet base 877, 878, 879 and T6567 frontal adjustment only with wrench no.26.

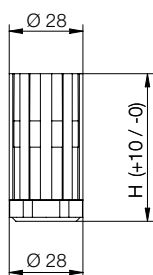

Code	H (mm)	min. order (No)	qty/box (No)	Kg/box
250FR28C06SF	60	1000	1000	31,00
250FR28C07SF	70	1000	1000	31,00
250FR28C08SF	80	1000	1000	31,00



Basi utilizzate:
Bases used:

- RB74S + P74SF
- RB84 + P74SF
- RBA85 + P74SF
- RBA76S

Ganci utilizzati:
Clips used:

- GZR54 H. 60 - 70 - 80
- GZR58 H. 70 - 80
- GZR60 H. 60 - 70 - 80

Base colonna frigo:
Refrigerator cabinet base:

- 877
- T6567
- 879
- 881

232F R50

Piedino conico H 70.
Conical leg H 70.

Con base frigo 877, 878, 879 e T6567

With refrigerator cabinet base 877, 878, 879 and T6567

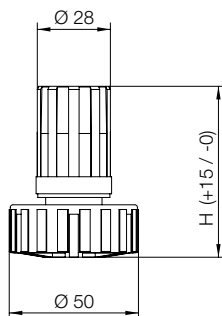

Code	H (mm)	min. order (No)	qty/box (No)	Kg/box
232FR5007SF	70	350	350	10,85



Basi utilizzate:
Bases used:

- RB74S
- RB84
- RBA85
- RBA76S

Ganci utilizzati:
Clips used:

- GZR54
- GZR60

Base colonna frigo:
Refrigerator cabinet base:

- 877
- T6567
- 879